

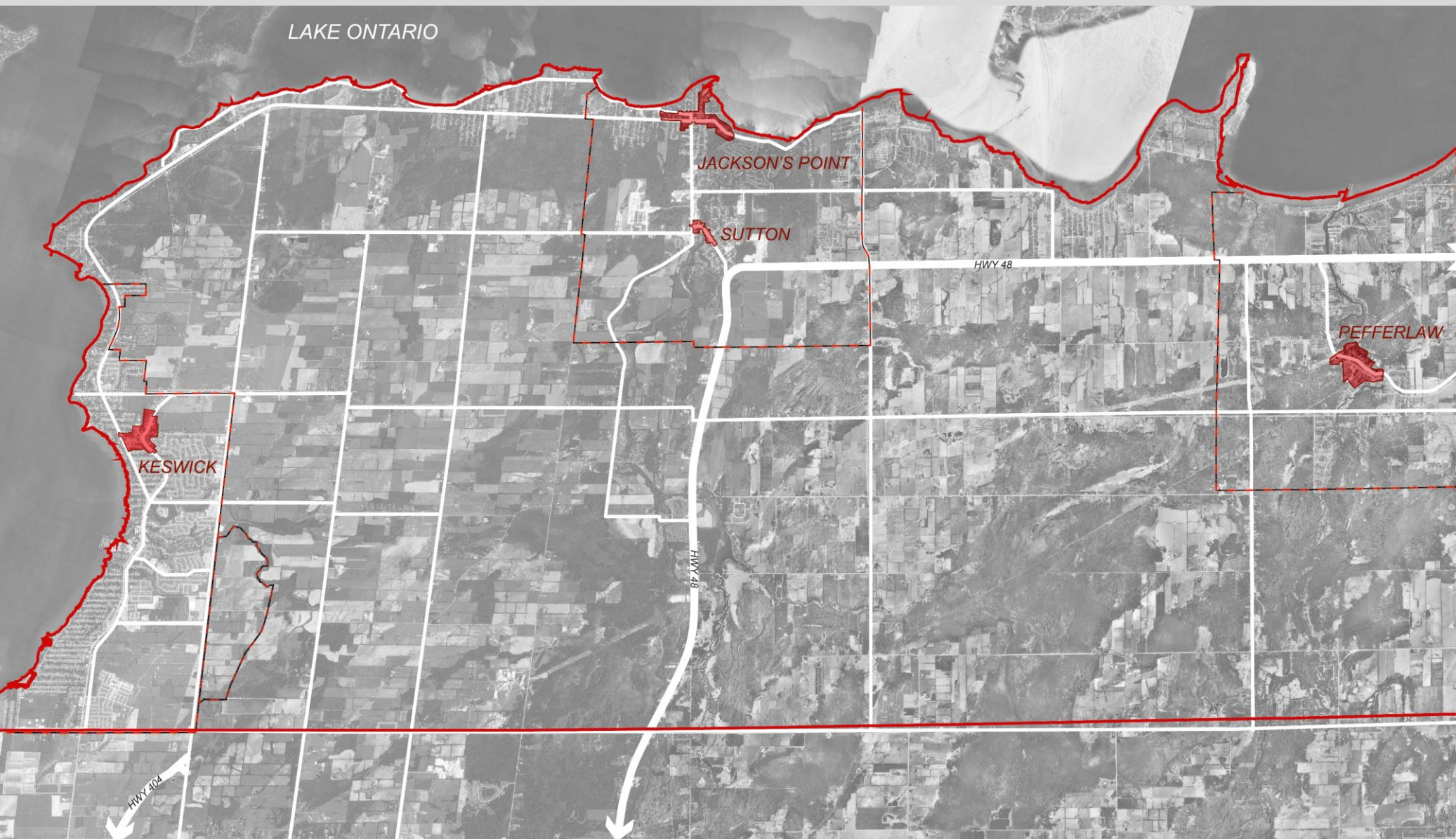



# Georgina Streetscape Improvement Plan Engagement Summary

May 19-th, 2021

# Project Study Area



## LEGEND

-  Town Boundary
-  Wards Boundary
-  BIA/BA Areas



## TOTAL RESPONDENTS

IN-PERSON AT POP-UP EVENTS:	68
IN-PERSON AT BIA MEETINGS:	11
ONLINE SURVEY:	185
<hr/>	
	264

## RESPONDENTS AT POP-UP EVENTS (2019):

SUTTON (July 20):	9
PEFFERLAW (August 5):	26
JACKSON'S POINT (August 10):	4
KESWICK (September 15):	18

## RESPONDENTS AT BIA EVENTS:

KESWICK (November 12, 2019):	5
ROC Chalet (February 25, 2020)	6

# Public Engagement Summary – Top 3 Answers

Q2: HOW DO YOU USE THESE STREETS?

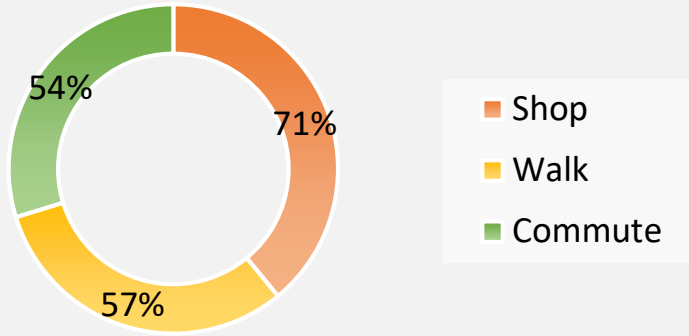

Q3: WHAT FUNCTIONAL AMENITIES ARE MISSING?

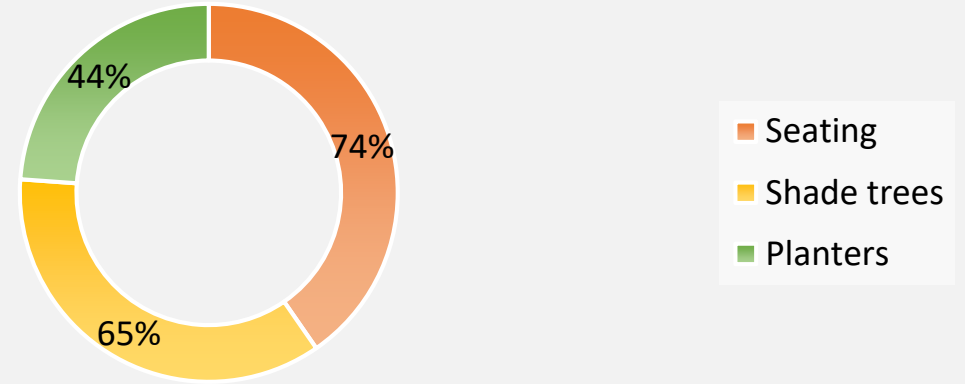

Q4: WHAT TYPES OF VISUAL DISPLAYS YOU PREFER?

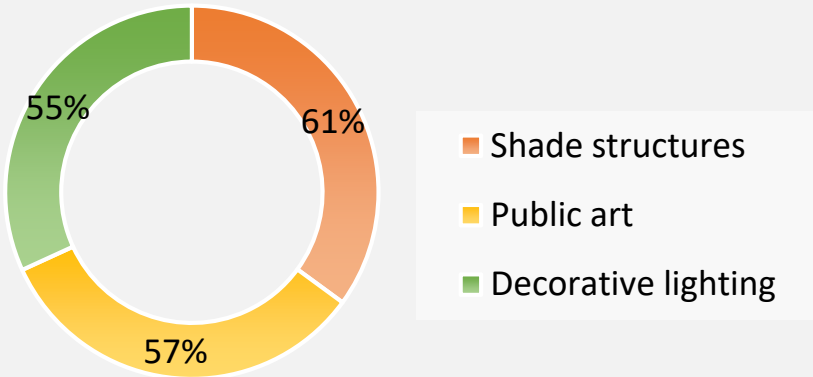

Q5: WHICH FUTURE READY IMPROVEMENTS?

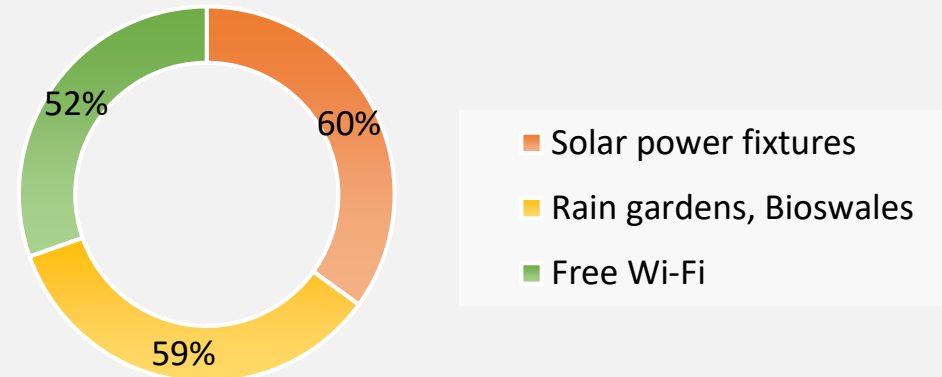



# Proposed Streetscape Typologies

## Major Street - Enhanced

Enhanced Streetscaping, Tree Grates and Soil Cells

(M1)



## Major Street - Standard

Standard Streetscaping, Raised Open Planters

(M2)



## Major Street - Basic

Basic Streetscaping, Planter Boxes

(M3)



## Special Street - Enhanced

Enhanced Streetscaping, Tree Grates and Soil Cells

(S1)



## Special Street - Standard

Standard Streetscaping (narrow), Planter Boxes

(S2)



## Special Street - Basic

Basic Streetscaping (wide), Planter Boxes

(S3)



## Green Street - Enhanced

Double Row of Trees in planters and grates

(G1)



## Green Street - Basic

Low Planters, Bioswales

(G2)



# Major Streets - application

These are streets with generally less pedestrian traffic and with higher vehicular volumes and speeds, outside BIA areas.



*Example: Metro Road South at Simcoe Ave, Keswick*



## Major Street - Enhanced

Enhanced Streetscaping, Tree Grates and Soil Cells

(M1)



## Major Street - Standard

Standard Streetscaping, Raised Open Planters

(M2)



## Major Street - Basic

Basic Streetscaping, Planter Boxes

(M3)





# Major Streets – design details



## Major Street - Enhanced

Enhanced Streetscaping, Tree Grates and Soil Cells

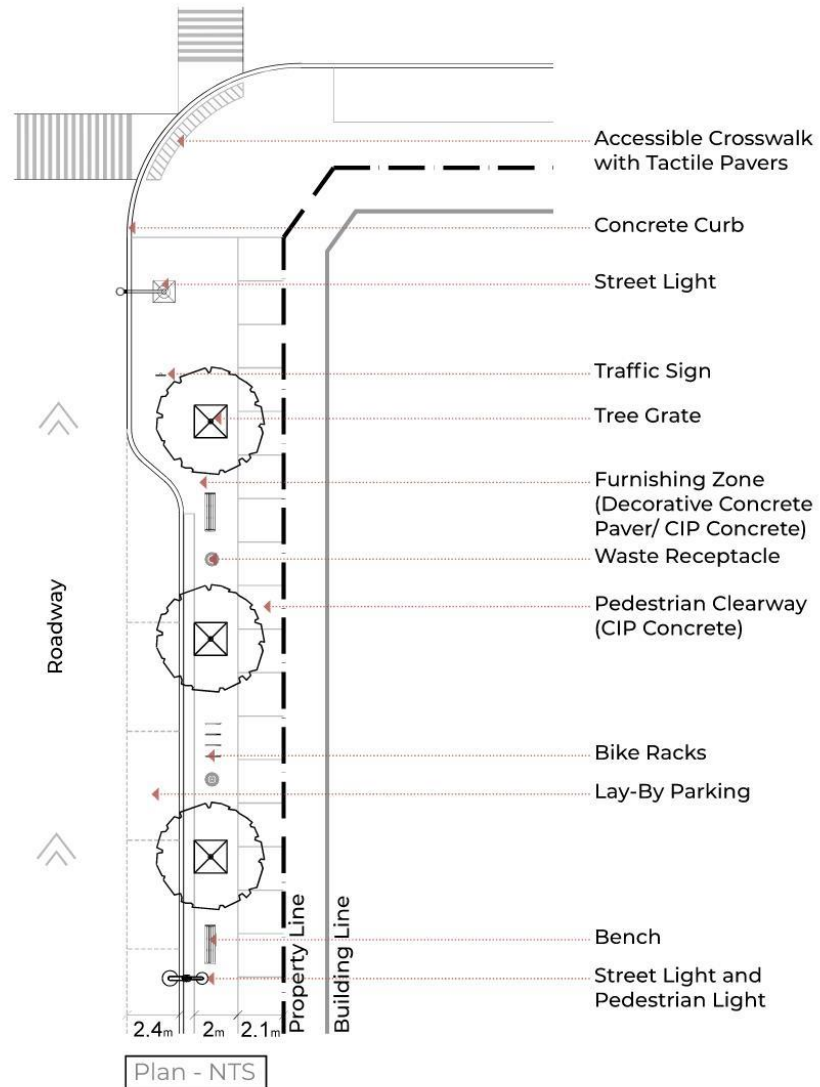

Plan - NTS

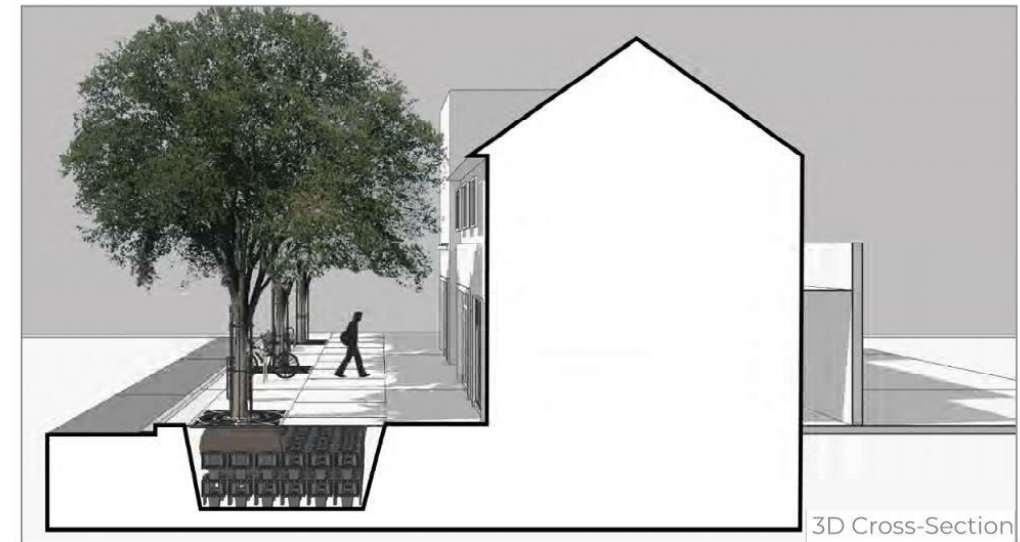

# Special Streets - application

These are streets within BIA areas with store fronts, heavy pedestrian traffic, and frequent destination arrivals.



*Example: The Queensway at Simcoe Ave, Keswick*



## Special Street - Enhanced

Enhanced Streetscaping, Tree Grates and Soil Cells

(S1)



## Special Street - Standard

Standard Streetscaping (narrow), Planter Boxes

(S2)



## Special Street - Basic

Basic Streetscaping (wide), Planter Boxes

(S3)





# Special Streets – design details



## Special Street - Enhanced

Enhanced Streetscaping, Tree Grates and Soil

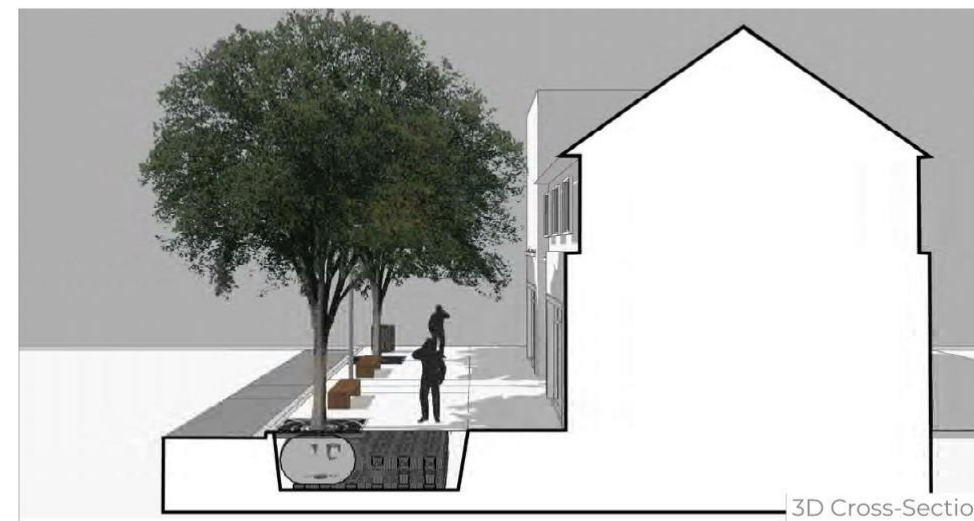
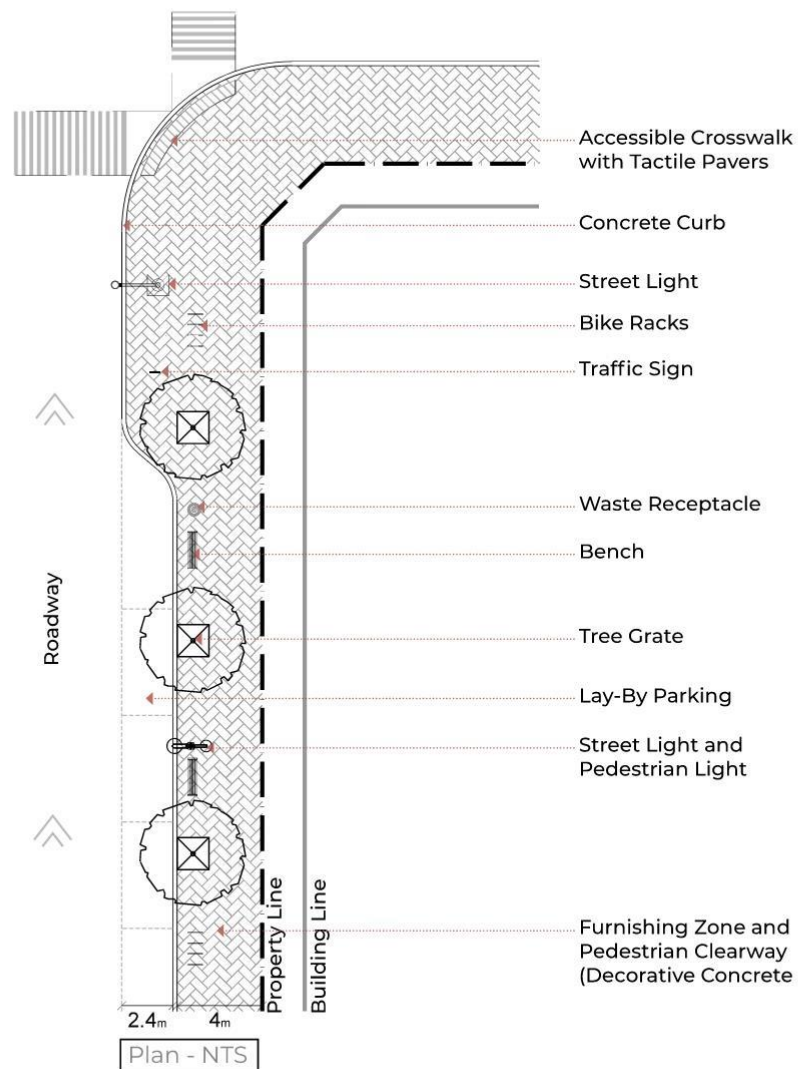

# Green Streets - application

These quiet streets are typically along identified cycling routes with ample landscaped features.



*Example: Biscayne Rd, Keswick*

## Green Street - Enhanced

Double Row of Trees in planters and grates

(G1)



## Green Street - Basic

Low Planters, Bioswales

(G2)





# Green Streets – design details



## Green Street - Enhanced Double Row of Trees in planters and grates

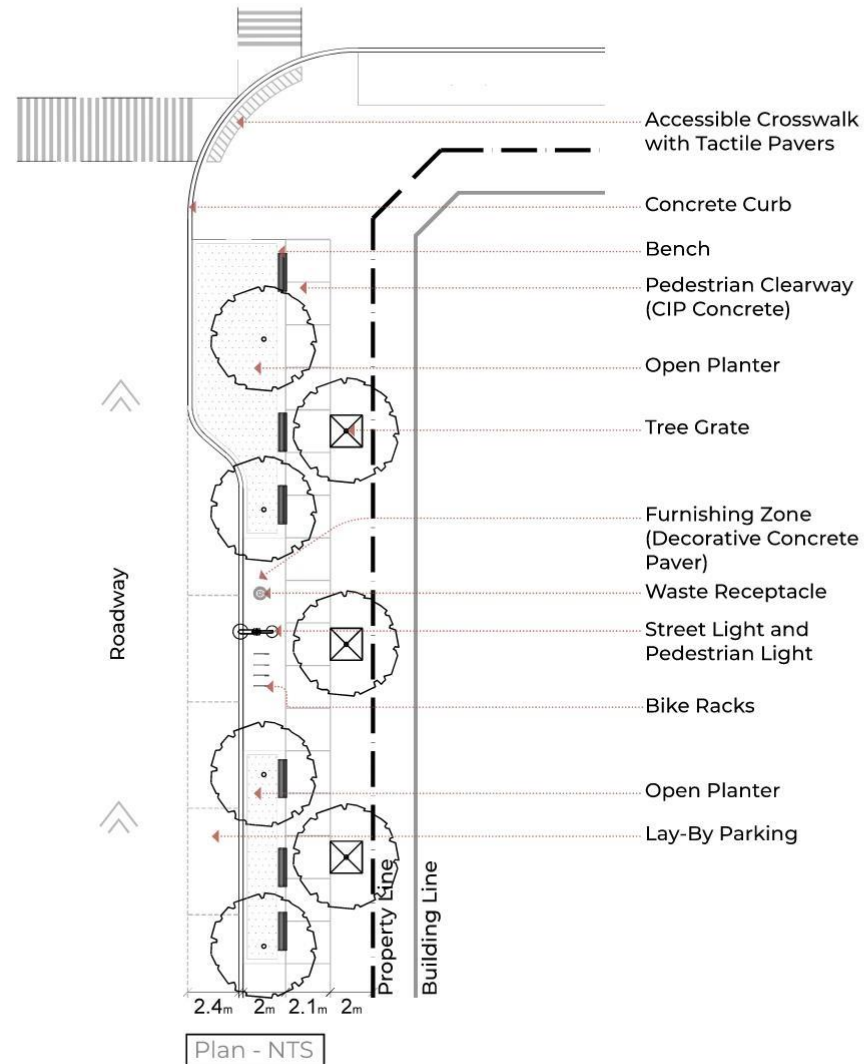



Thank You

# Q2: What types of improvements are important to you?

## KEY FINDINGS:

- 18% Parking
- 18% Lighting and Signage
- 18% Façade improvements

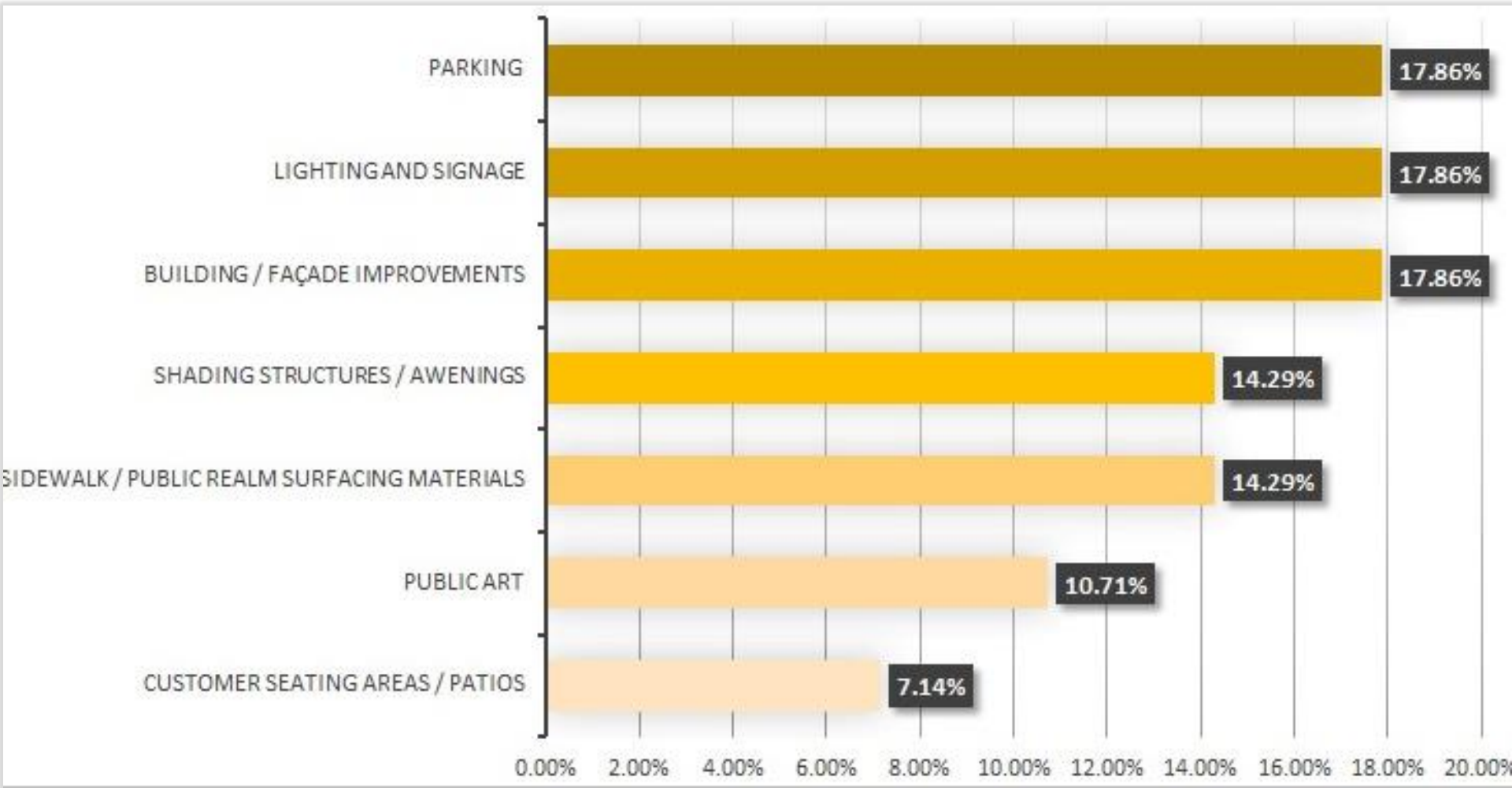

# Q2: How would you prioritize the improvements?

## KEY FINDINGS:

- #1 Lighting and Signage
- #2 Paving / Surfacing
- #3 Parking
- #4 Planting

