



GEORGINA

Arnold Estate

Old published maps of North Gwillimbury Township are (in some places) labelled “Arnold Estate”. These were lands granted to traitor to the American Revolution, Benedict Arnold. In 1798, he applied for land in Upper Canada and in 1799 received a grant of 13,400 acres. 5000 for himself and 1200 for his wife and each of his 6 children who had not already acquired land in Upper Canada. His grant was taken up in East and North Gwillimbury, and Elmsley Townships.

He never saw the land; he died in 1801 and the estate was divided among his children. This was eventually sold off and appears to be out of the hands of his descendants by the 1880s.

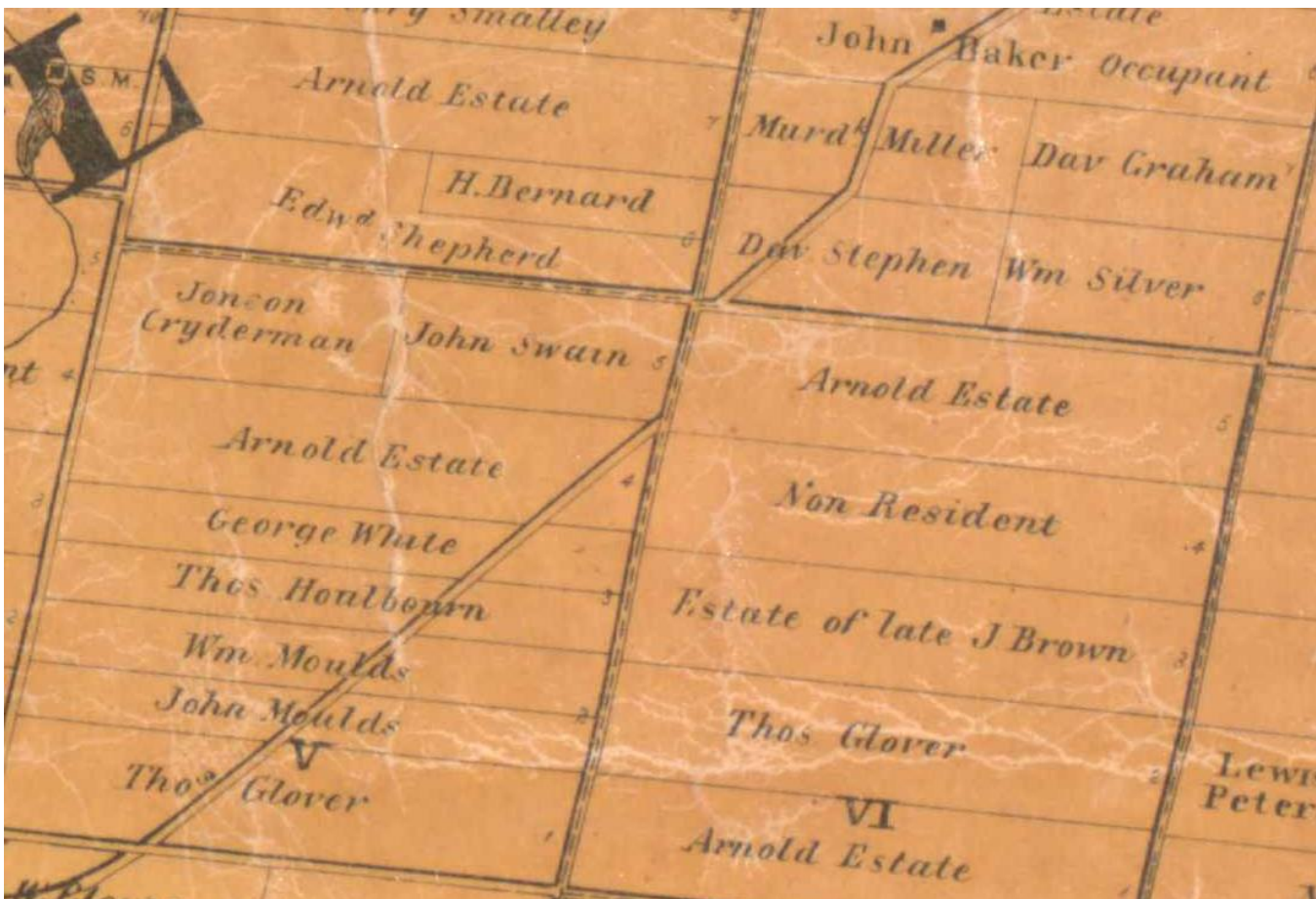

Tremaine's Map of the County of York, Canada West, 1860, showing a portion of North Gwillimbury Township.