

Town of Georgina

Waterfront Parks Master Plan

Public Engagement 2
Emerging Concepts

November 21 and 22, 2020

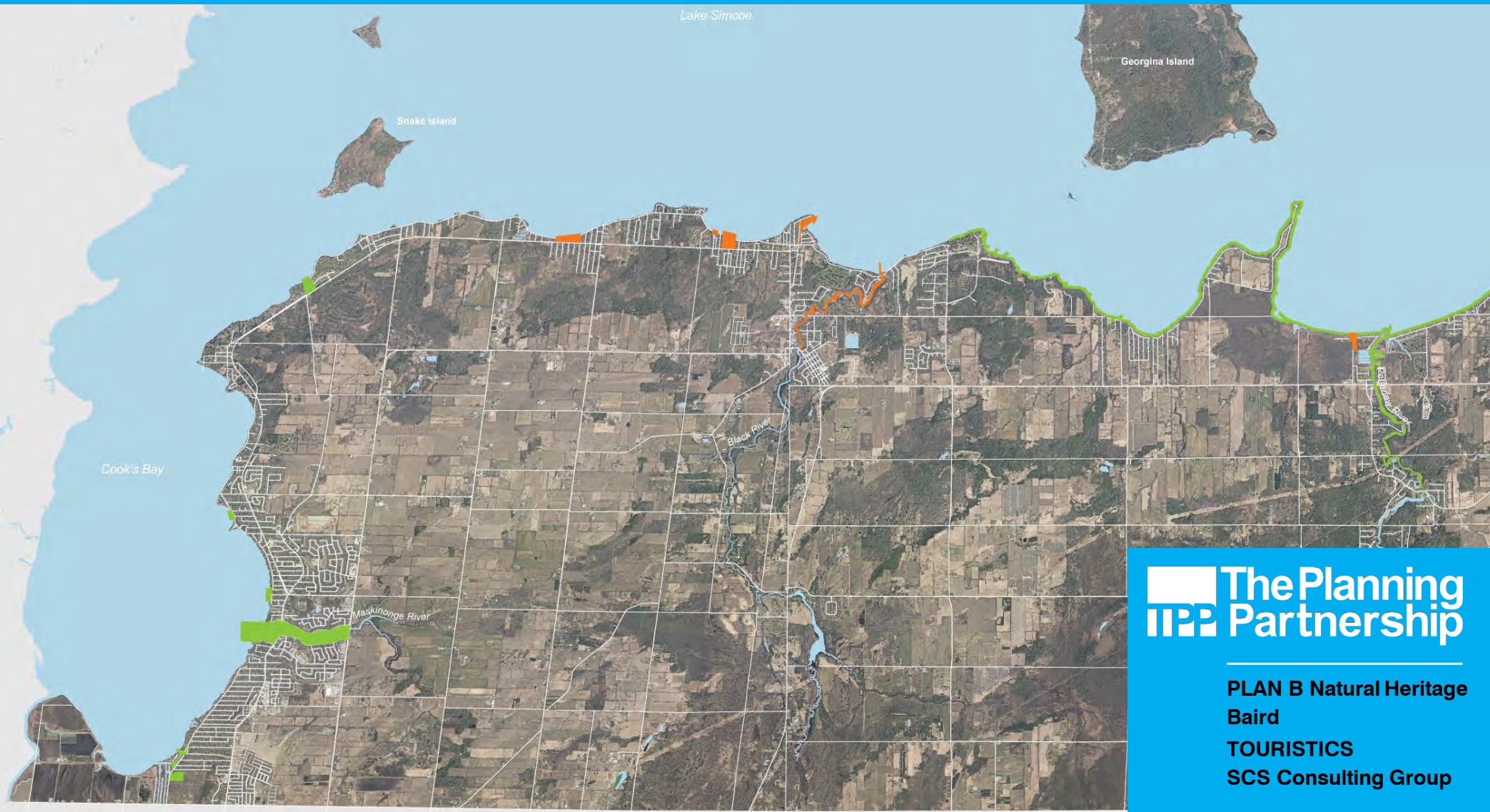

 **The Planning
Partnership**

**PLAN B Natural Heritage
Baird
TOURISTICS
SCS Consulting Group**

Zone 2 De La Salle Park – You wanted.....



- Notices at the beach re: water quality
- Buoys to keep boats away from the swimming area
- Connect north and south lots with a driveway so people don't have to go out to the adjacent roads
- Designate the north lot for residents, and more parking on Jericho lands
- A bigger strategy for parking that includes parking off site with shuttle
- Better management of parking
- Add an education centre
- Upgrade washrooms,
- Storage racks for canoes/kayaks
- Make sure we can accommodate year round use: ice fishing and snow machines

Zone 2 De La Salle Park – What we heard.....

Spectrum of opinion on Lake Drive

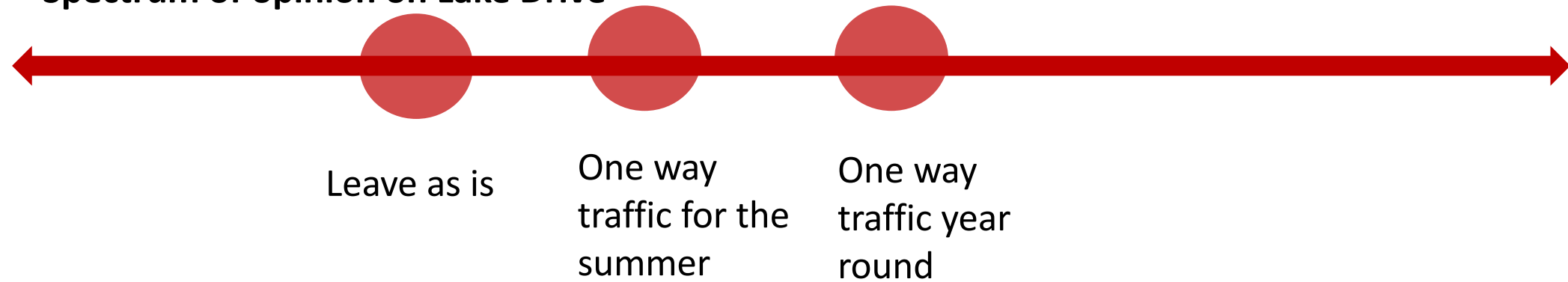

Full spectrum of opinion on new commercial/retail/food at De La Salle

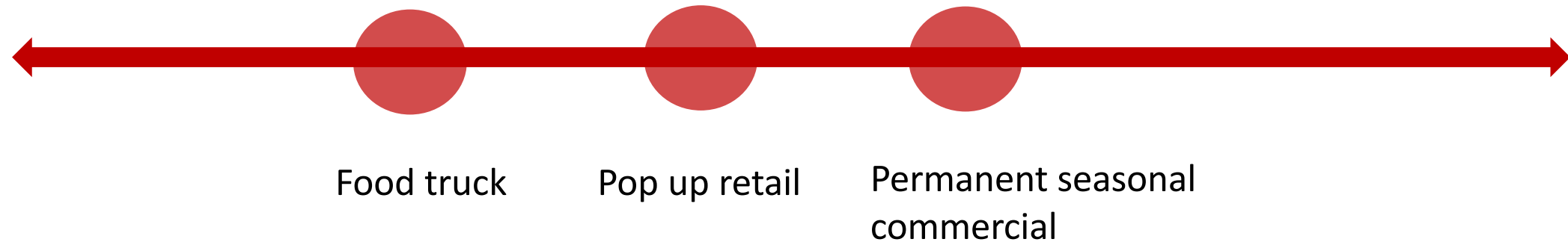

Zone 2 De La Salle Park – Emerging Concept



1. Lakefront pedestrian /cycling promenade
2. Lake Drive redirected through the park
3. Parking areas distributed along the new park drive
4. Walkway along Metro Rd. N
5. Strolling circuit / adult fitness stations
6. Events plaza / hard surface play court (basketball)
7. Expanded playground / adventure play area
8. Frisbee golf/ adventure play in wooded area
9. Existing beach volleyball
10. Large stone/stepped seating / ramp to beach / look-out area
11. New walkways
12. Additional picnic tables / shelters
13. New Waterfront Parks family of site furnishings and 'themed' elements

Lake Drive – cuts off the park from the water + gives priority to cars



Pedestrians cross underground through a dark and unsafe hole



Permanent Road Closures at Parks



Lake Wilcox Park, Richmond Hill:

Old Bayview Avenue closed to connect the park to the lake and create a pedestrian promenade.

Permanent Road Closures at Parks



Lake Wilcox Park, Richmond Hill:

Old Bayview Avenue close to connect the park to the lake and create a pedestrian promenade.

Permanent Road Closures at Parks



Lake Wilcox Park, Richmond Hill:

Old Bayview Avenue close to connect the park to the lake and create a pedestrian promenade.

Seasonal Road Closures at Parks

“Our parks are for people, not cars. For more than a century, cars have turned parts of the world’s most iconic parks into highways. Today, we take them back. We are prioritizing the safety and the health of the millions of parents, children and visitors who flock to Central Park.”

Aurora - Wells Street closed to traffic at the Farmer’s Market every weekend (and every day at lunch when the school was in use).

Toronto - High Park is closed to traffic on weekends, proposal to close the main loop road to cars year round

Toronto - *Major Weekend Road Closures began in mid-May and were in place for 25 consecutive weekends through the end of October. The program was extended twice – into September and again through October...* Included Lakeshore Boulevard.

De La Salle Park – Lake Drive Option



Seasonal Closure

- Closed to traffic July – August
- Temporary turnaround at either end of park
- Paved roadway used as pedestrian promenade
- Park is connected to the beach
- Re-route traffic to Metro Road in summer
- Lake Drive for local access only
- Re-open after Labour Day

Traffic directed to Metro Road in July and August



Lake to Lake connection – ideas being explored today

Lake Drive Sidewalk View Location

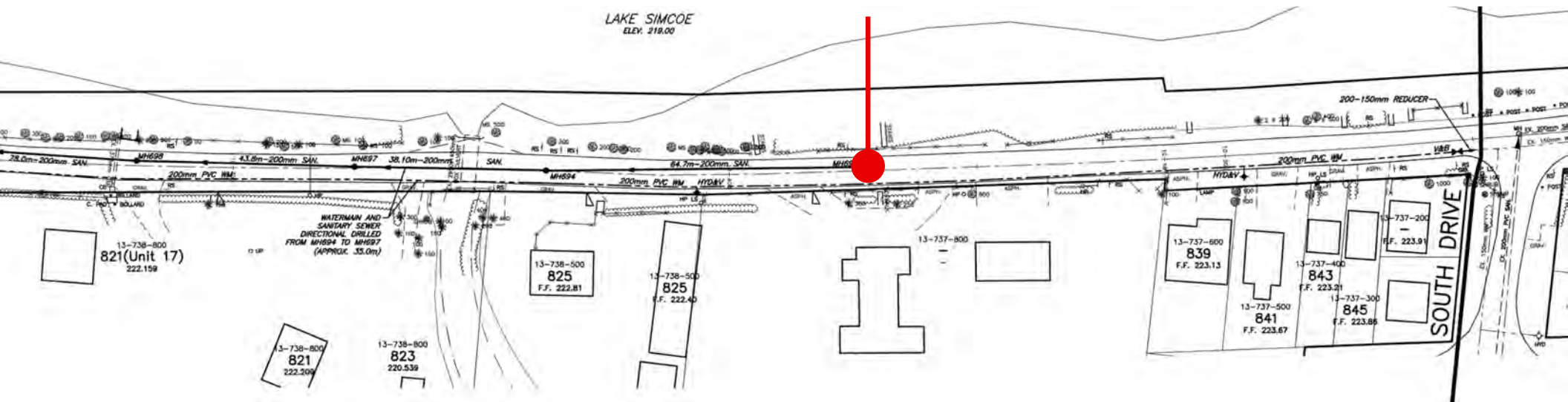

Lake to Lake connection – ideas being explored today

Lake Drive walk: From Jackson's Point to De La Salle Park



Lake to Lake connection – ideas being explored today

Lake Drive walk: From Jackson's Point to De La Salle Park



Lake to Lake connection – ideas being explored today

Lake Drive walk: From Jackson's Point to De La Salle Park



De La Salle Park – ideas being explored today

Existing Washrooms: Create a new deck to overlook the beach and lake.



De La Salle Park – ideas being explored today

Existing Washrooms: Create a new deck to overlook the beach and lake.



Manage capacity at the beach

Beach Area
7,500 sm



Rule-of-Thumb
6.4 sm / person



Capacity
1,150 persons



Manage capacity at the beach - Example

Bay Beach, Fort Erie (Before)



Manage Capacity at the beach - Example

- Added Gate Control
- New Charge for admission:
 - \$10 season pass (permanent & seasonal residents)
 - \$5 per visit for visitors
- New Parking Meters on streets within 500m of park
- Permit system for residents who can't park on their property (confirmed on a case-by-case basis)
- New rules: No tents, umbrellas only

Town has “far surpassed the revenue that was estimated”



Bay Beach, Fort Erie (After)



Bay Beach beach overlook and admissions gate



SUITE OF DESIGN ELEMENTS FOR WATERFRONT PARKS

Brand the Waterfront | consistent, coordinated
and recognizable design elements and features

Connect the Parks |
thematically tie the parks through
unifying and common elements and
furnishings

Make it Beautiful, Comfortable & Inviting |
high quality, low maintenance thematically

Incorporate Sustainability |
thematically

Permanent Washrooms | designed as 'gems' in the park



Temporary Washrooms | seasonal & special events



Pergolas | dappled shade & beautiful focal elements



Shade Structures | every day and special events



Seating and Gathering | benches, tables, furniture

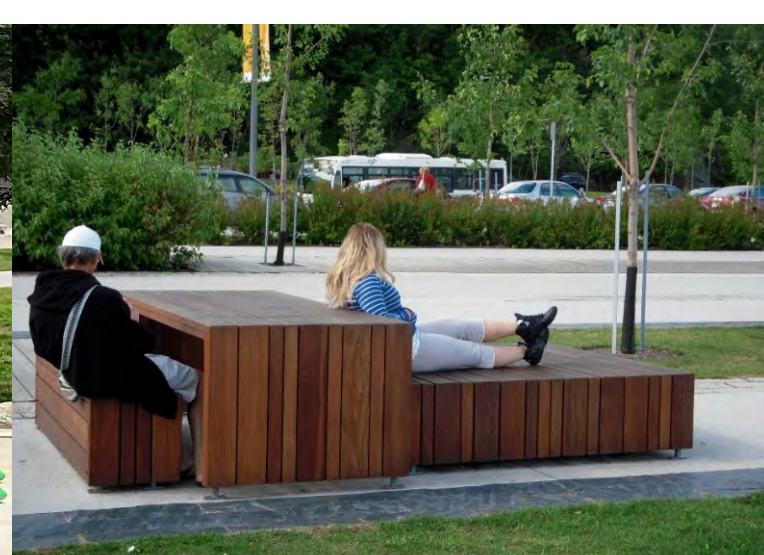

Sense of Place | tell a story of the place

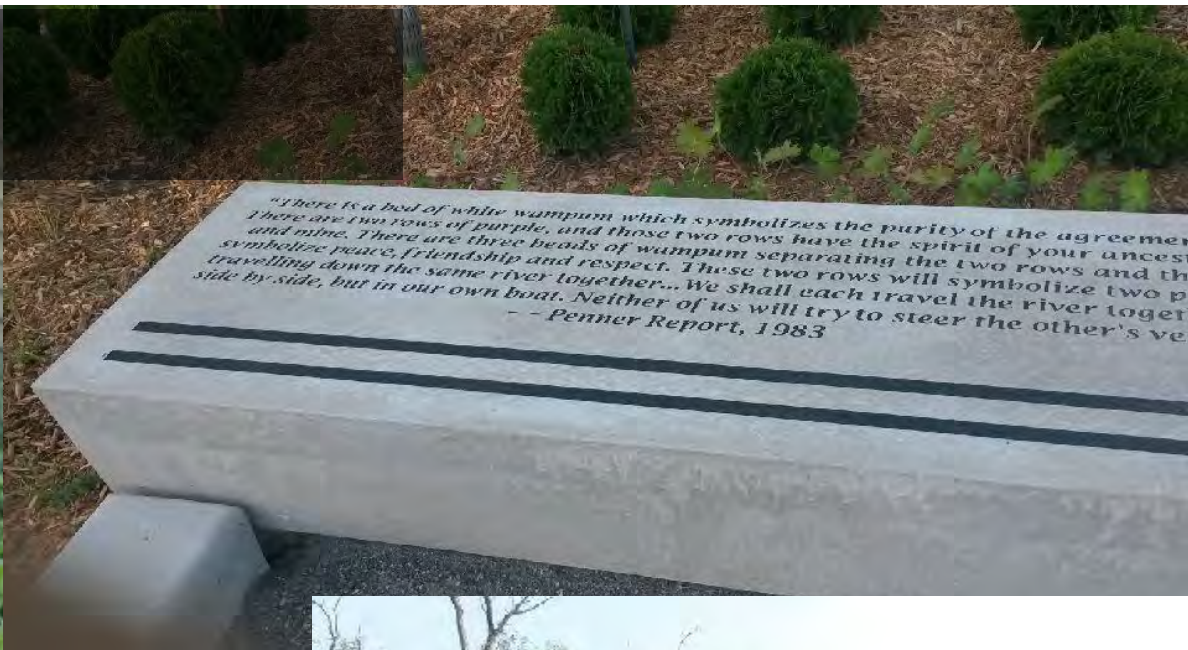

Play and Explore |

Adventure playground



Exercise and Fitness |

trail fitness, exercise equipment



Fitness Circuit |

Barrie Waterfront

Barrie Waterfront Fitness Circuit

Area 1
Sit Up
Bars
Pull Up-Strength

Area 4
Hip
Cross (2)

Area 2
Chest
Back
Leg Press

Area 5
Chest
Back
Springer

Area 3
Double Airwalk
Hip
Twister

Area 6
Combination
Unit

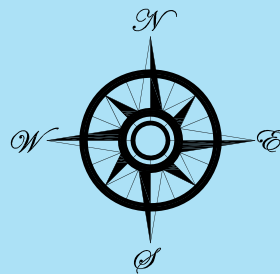

Kempenfelt Bay

LAKESHORE DR

Drainage & Grading |

Bioretention Swales



Kiosks | Pop Up + Permanent

Food & Beverage, Rentals, Stores



Activities |

Youth, Adults and Seniors



Activities | Skate Park

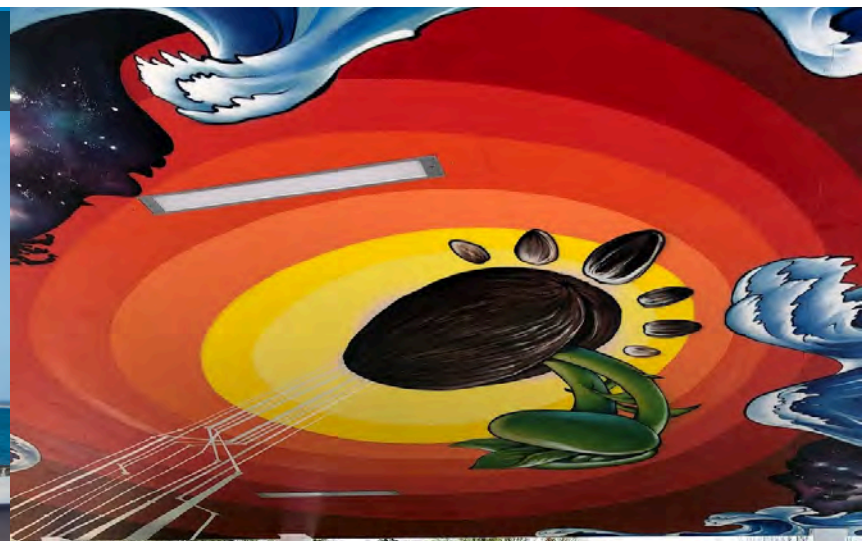

Special Paving | defining spaces and movement



Signage |

Distinct identity, provides context to the park system, is positive and welcoming



Signage |

Let's people know where they are and how to behave in a positive and welcoming way



WATERFRONT PARK EST. 2000

- This Park is a legacy to the residents and visitors of Wolfville. Please help to keep it safe and enjoyable by following these guidelines:
- enjoy these premises with respect and courtesy without misuse or damage to the property.
 - clean up immediately after your pet.
 - use waste receptacles.
 - no bicycles or skateboarding permitted.



Thank YOU
for not parking in the Jams Lot

The Neighbourly Relations
Committee

Signage | nature and heritage interpretation

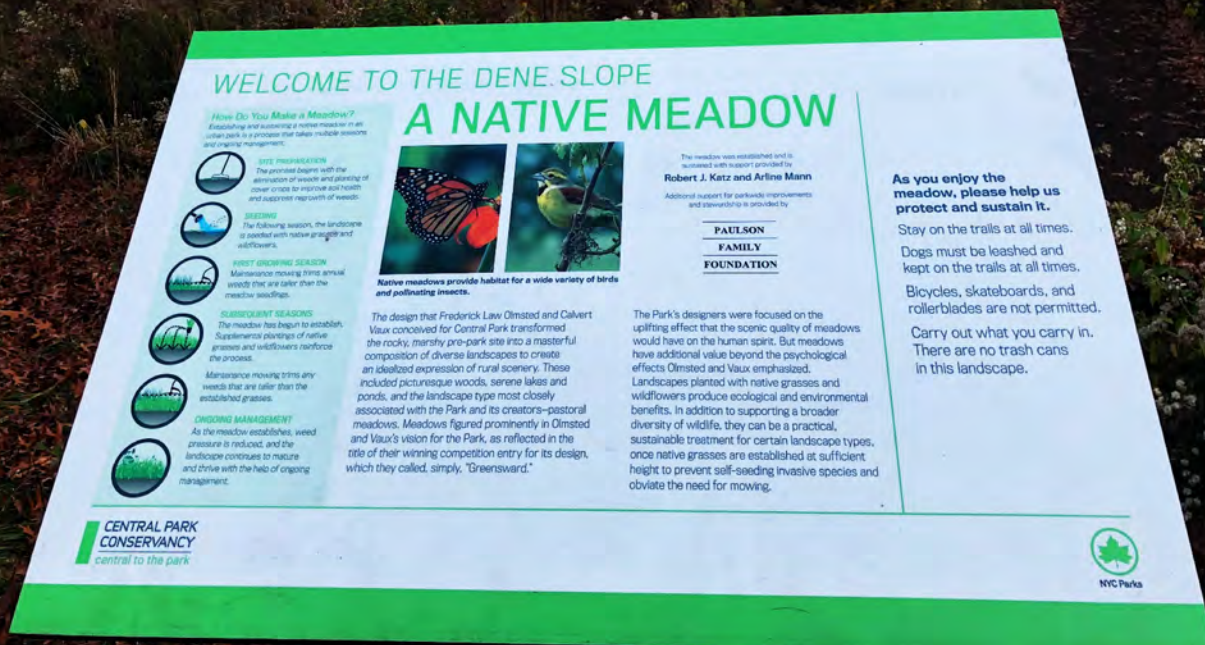
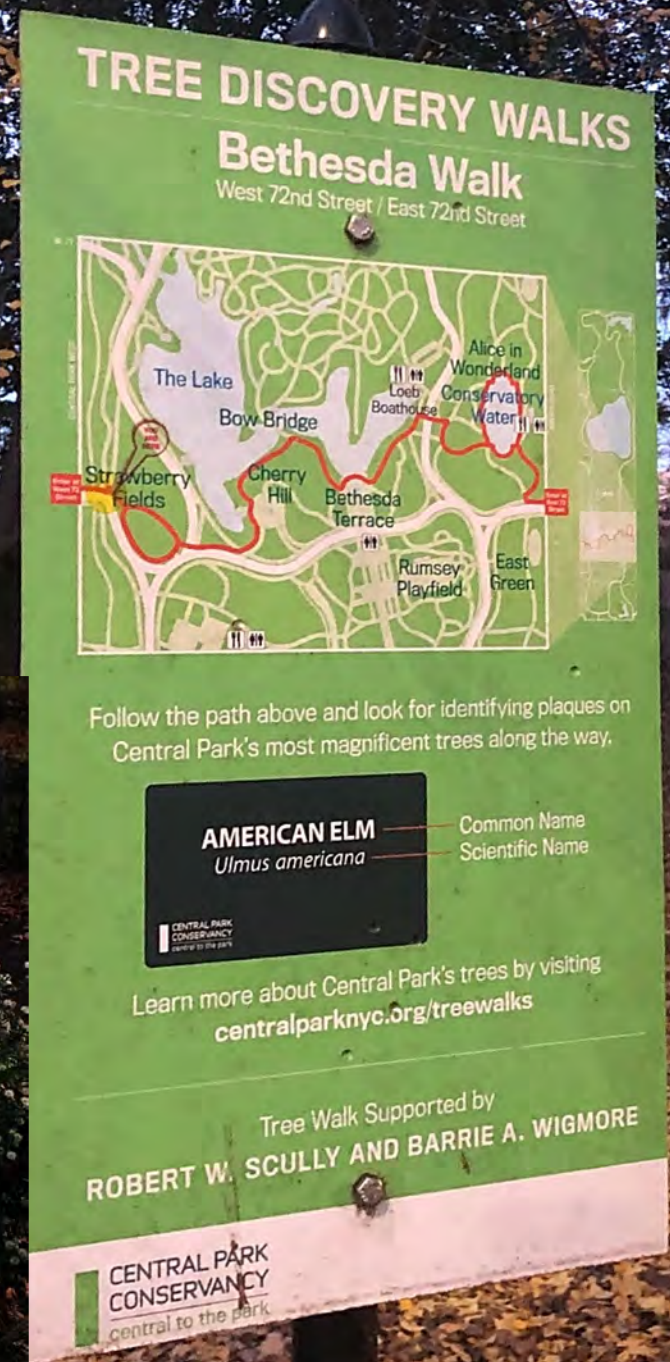

Winter Activities |

Ice fishing, skating, snowmobiles



Space for Events | Markets, Festivals, Music, Movies

